



Installation Instructions

Stop  **Ambush**

PROFESSIONAL INSTALLATION RECOMMENDED

Stop  **Ambush**

PROFESSIONAL INSTALLATION RECOMMENDED

Stop  **Ambush**

PROFESSIONAL INSTALLATION RECOMMENDED

Ensure all contents are included in the package

- 2 Sensors (either black or white)
- Display Unit with Bracket
- Cable Harness

Display Bracket
Pre-cut and attached for easy installations



Standby Button

On/Off Switch

Directional Arrows

Speaker

Volume Buttons

Display Unit with Bracket

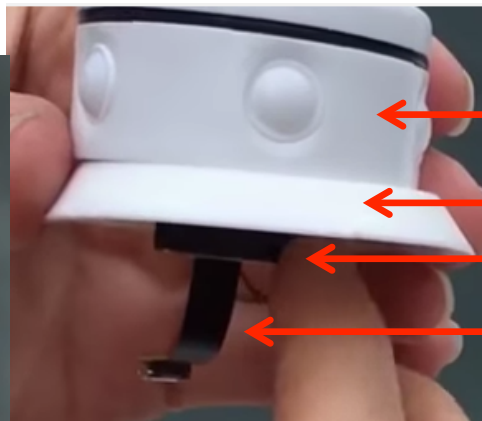

Sensor Pod

Waterproof Gasket

Washer

Micro USB

Sensor Pod
Please handle the sensor pods with care.



Display Input

2 Micro USB
Plugs into sensor pods

Power Source Wiring
Connects to any 12 volts power source inside the vehicle

Cable Harness

StopAmbush Placement for Various Vehicles

Refer to the diagram below before installing StopAmbush

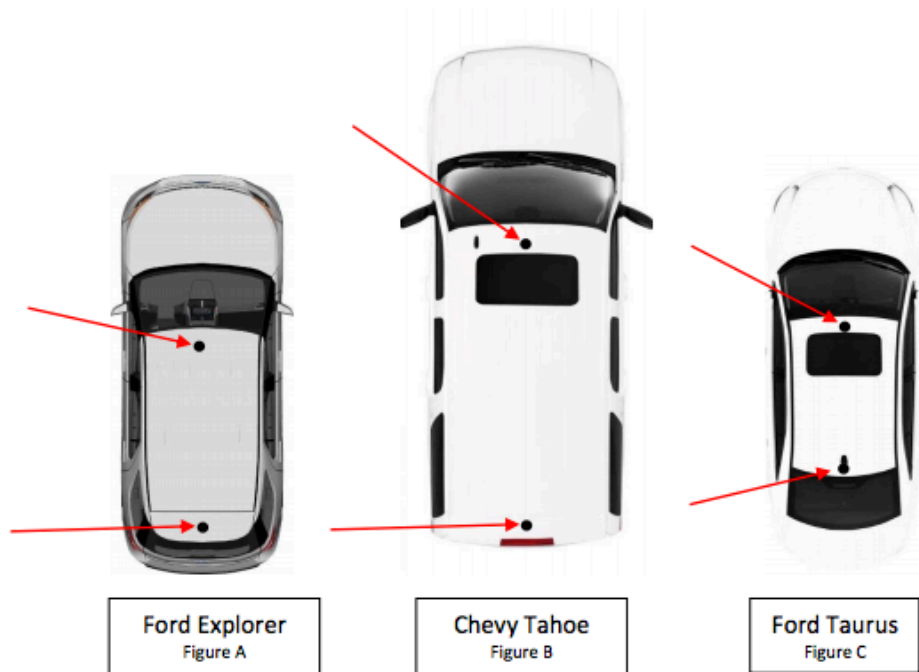

These images are not to scale and for reference only.

The arrows point to the approximate pod position for each vehicle. These are the manufacturer's suggested position placements for optimal system effectiveness. Installation may vary depending on the structure of each vehicle.



Ensure that no antennas or ancillaries are attached to the roof on the front and side of the pods (indicated by the shaded area in Figure D).

Any further questions, please call: 561-779-5515

Instructions



1. Inside of the front of the vehicle, remove the dome light and locate the sheet metal roof under the liner.

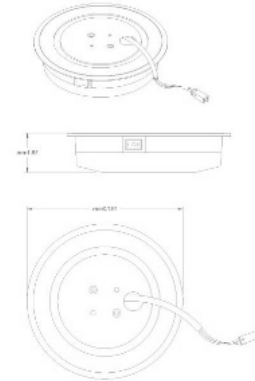

2. Using a $\frac{9}{16}$ inch metal drill bit, drill a hole through the center of the sheet metal.
3. Partially remove the rear liner closest to the rear windshield.
4. Locate the center of the roof laterally and measure at least $6\frac{1}{2}$ inches or more back from the edge of the rear top gasket of the rear windshield. Drill a $\frac{9}{16}$ inch hole through the sheet metal.
5. Going back to the front hole, locate any 12V power source wire inside the roof liner connected to the dome light. Connect the positive wire (red) to the source and the negative wire (black) to a negative line.



6. Insert the wire harness over the top of the liner to bring the longest small connector (micro USB) to the rear of the vehicle and the short one in the area of the front hole by the dome light.

Lock the Sensor unit in place plug in the micro USB.

7. Loosen the driver side sun-visor to allow for the display wire to be *carefully* snaked approximately 4 to 5 inches out from under the liner.

8. *Carefully* snake the display connector over the liner and through the front area of the right side mount of the sun-visor.

BE GENTLE WITH WIRING TO AVOID DAMAGE



9. Using a second person and **extra care** with the micro-USB connector on the sensor, drop the threaded section of the sensor through the predrilled $\frac{9}{16}$ inch hole.

10. Align the sensor with the lock screw following the longitudinal axes of the vehicle and the middle sensor facing forward. Lock the unit using the locking screw attached (Assure proper setting of the gasket). Repeat the step with the rear sensor screw facing forward with the longitudinal axis and the middle sensor

pointing rearward.

11. Connect the male micro-USB into the sensor female connector assuring a proper connection.
12. Re-install the sun-visor, and before completely tightening the right-side mount slide the bracket of the display under it and fasten in place.
13. Insert the wide connector into the display female connector located at the top of the display.
14. Using the side slide power switch turn StopAmbush on and conduct testing before locking the liner and the dome in place.



Specs:

White Button:

Front top center-standby/deactivate mode with amber light next to it ON.

POWER switch:

Located on the side, when the switch is slid, the entire device powers on.

Yellow Buttons:

Up/Down volume control



If you have any questions about installing StopAmbush, do not hesitate to call

(561) 779-5515 or email

StopAmbush@gmail.com

A Complete Installation Tutorial Video can be viewed at www.stopambush.com/installation



PRODUCT LIABILITY DISCLAIMER

TERMS OF USE, WARRANTY & LIABILITY WAIVER

StopAmbush Inc., offers its products with the terms, conditions and notices as follows:

Terms of use

This product is offered to you conditioned upon your acceptance without modification of the terms, conditions, and notices contained.

Exclusive Obligation

This product has been designed for a variety of uses. StopAmbush Inc., is a device to be used to enhance alertness and increase situational awareness. This product may not be used for unlawful purposes and that use is expressly prohibited under the terms and conditions of it's use.

Use limitation

You may not modify, copy, distribute, transmit, display, perform, reproduce, publish, license, create derivative works from, transfer, or sell, any information, software, products or services obtained, from the StopAmbush Inc., website or its products.

One Year Warranty

This product is warranted against any manufactured defect for a period of twelve months from date of purchase.

Limitation Of Liability

In no event shall StopAmbush Inc., be liable for any direct, indirect, punitive, incidental, special consequential damages whatsoever arising out of or connected with the use or misuse of it's products.

Other Statements

StopAmbush Inc., employees or representatives, ORAL OR OTHER WRITTEN STATEMENTS, DO NOT CONSTITUTE WARRANTIES, shall not be relied upon by buyer, and is not part of the contract for sale or this limited warranty.

Entire Obligation

The TERM OF USE, WARRANTY AND DISCLAIMER document states the entire obligation of StopAmbush Inc., with respect to the products. If any part of this disclaimer is determined to be void, invalid, unenforceable or illegal, including, but not limited to the warranty disclaimers and liability disclaimers and liability limitations set forth above, then the invalid or unenforceable provision will be deemed superseded by a valid, enforceable provision that most closely matches the intent of the original provision and the remainder of the agreement shall remain in full force and effect.

General

This disclaimer statement is governed by the laws of the State of Florida, USA. You hereby consent to the exclusive jurisdiction and venue of the Courts of competent jurisdiction, USA, in all disputes arising out of or relating to the use of this product. Use of this product is unauthorized in any jurisdiction that does not give effect to all provisions of these terms and conditions, including without limitation this paragraph.

Modification of Terms and Conditions

StopAmbush, Inc., reserves the right to change the terms, conditions, and notices under which their products are offered.